



Diaphragm Meter Parts List

Diaphragm Meter Parts List
September 27, 2023
815-0025-00 REV 005

Copyright © 2023 Itron Inc. All rights reserved.

Confidentiality notice

Confidential information of Itron® Inc., provided under nondisclosure obligations. The information contained herein is proprietary and confidential and is being provided subject to the condition that (i) it be held in confidence except to the extent required otherwise by law and (ii) it will be used only for the purposes described herein. Any third party that is given access to this information shall be similarly bound in writing.

Trademark notice

Itron and the Itron logo are trademarks of Itron® Inc., registered in the United States and other countries and regions.

All other product names and logos in this documentation are used for identification purposes only and may be trademarks or registered trademarks of their respective companies.

For more information about Itron or Itron products, go to www.itron.com

For more information about Itron trademarks, go to [Itron's Trademarks and Brands](#)

For product help, contact Itron Technical Support Services.

Contact

Email: support@itron.com

Itron Customer Center: customer.itron.com

Products and documentation: products.itron.com

Itron Technical Support North America: 1-877-487-6602

For regional technical support, go to www.itron.com and select your country and language.

For suggestions, questions, or other feedback concerning Itron product documentation, contact us at: ItronDocumentation@itron.com

Contents

New in this document	5
1 Introduction	6
2 Parts List	7
Meter Top Assembly (Top Casting, IDM, Hubs)	7
Meter Castings	8
Hand Hole Cover	8
IDM Assembly	8
Seal Unit Assembly	9
Drive Dog	9
Gaskets and O Rings	9
Index Mounting Bracket Assembly	10
Indexes	10
Index Covers	11
Security Seal	11
Seal Cup	12
Valve Covers	12
Valve Cover Bearing	12
Valve Seat	12
Ceiling Plate	13
Extension Plate	13
Diaphragm Assembly	13
Diaphragm Bracket	13
Carrier Wire Assembly	14
Main Shaft Assembly	14
Thrust Bearing	14
Tangent Adjustment Assembly	14
Center Bracket Assembly	15
Center Bracket Seal	15
Center Bracket Lower Bearing	15
Tangent Crank	15
3 Badges	16

4 Screws	17
5 Special Tools	19
6 Meter Connections	20
10LT Swivels	20
10 LT Connection Nut Washer	20
10 LT Connection Nut Tin	21
10 LT Connection Nut Washer	21
#1 Sprague/1A Standard Swivels	21
#1 Sprague/1A Standard Connection Nut	22
#1 Sprague/1A Standard Connection Nut Washer	22
#1 Sprague/1A Standard Connection Blind Washer	22
1-1/4" (1" Pittsburgh) Swivels	22
1-1/4" (1" Pittsburgh) Connection Nut	23
1-1/4" (1" Pittsburgh) Connection Nut Washer	23
20 LT Swivels	23
20 LT Connection Nut	23
20 LT Connection Nut Washer	24
20 LT Connection Nut Tin	24
30 LT Swivels	24
30 LT Connection Nut	24
30 LT Connection Nut Washer	24
30 LT Connection Nut Tin	24
45 LT Swivels	25
45 LT Connection Nut	25
45 LT Connection Nut Washer	25
#3 Sprague (#4) Swivels	25
#3 Sprague (#4) Connection Nut	25
#3 Sprague (#4) Connection Nut Washer	26
#5 Swivels	26
#5 Connection Nut	26
#5 Connection Nut Washer	26
100 LT Swivels	26
100 LT Connection Nut	27
100 LT Connection Nut Washer	27

New in this document

Table 1

Revision	Date	Description
REV 005	September 27, 2023	<ul style="list-style-type: none">Removed TC- and NTC-specific badge part numbers from Badges on page 16
REV 004	March 6, 2023	<ul style="list-style-type: none">Updated table in Valve Seat on page 12
REV 003	February 2, 2023	<ul style="list-style-type: none">Updated 400A side cover part numbers in Gaskets and O Rings on page 9Added 675, 800A & 1000A standard 5-circle dial to Indexes on page 10
REV 002	June 28, 2022	<ul style="list-style-type: none">Removed all references to METRIS and I-250

1

Introduction

This comprehensive catalog of diaphragm meter parts for Itron, Inc. contains parts for meters in current production. All parts information and descriptions in this document are believed to be accurate, but are not guaranteed. Some parts may not be backward compatible with older versions of the product type. For information about part numbers, descriptions or assemblies in previous models of Sprague, Schlumberger, or Actaris meters, contact Itron Support Services at 1-877-487-6602. This parts list is effective September 27, 2023.



2

Parts List

Meter Top Assembly (Top Casting, IDM, Hubs)



Meter	Part Description	C to C	Part Number
400A	#4 Sprague standard (ft ³)	6-25/32"	109390-001
400A	#4 Sprague standard (ft ³)	8-1/4"	109394-001
400A	20 LT (ft ³)	6-25/32"	109391-001
400A	20 LT (ft ³)	8-1/4"	109395-001
400A	30 LT (ft ³)	7"	109367-001
400A	30 LT (ft ³)	6-25/32"	109392-001
400A	30 LT (ft ³)	8-1/4"	109396-001
400A	45 LT (ft ³)	6-25/32"	109393-001
400A	45 LT (ft ³)	8-1/4"	109397-001
675A	TOP ASSY 45LT HUB ET FT3 675A 10IN C/L	10"	109627
675A	TOP ASSY 100LT M3 675A 10IN C/L	10"	109675
675A	TOP ASSY #4 HUB ET FT3 675A 10IN C/L	10"	109625
675A	Top ASSY 30LT HUB ET FT3 675A 10 IN C/L	10"	109626
675A, 800A & 1000A	#5 Sprague Standard (ft ³)	11"	109600
675A, 800A & 1000A	30 LT (ft ³)	11"	109605
675A, 800A & 1000A	45 LT (ft ³)	11"	109601
675A, 800A & 1000A	60 LT (ft ³)	11"	109602
675A, 800A & 1000A	100 LT (ft ³)	11"	109603
675A, 800A & 1000A	ET Top #5 Sprague Standard (ft ³)	11"	109641
675A, 800A & 1000A	ET top 30 LT (ft ³)	11"	109649

Meter	Part Description	C to C	Part Number
675A, 800A & 1000A	ET top 45 LT (ft³)	11"	109643
675A, 800A & 1000A	ET top 100 LT (ft³)	11"	109651

Meter Castings

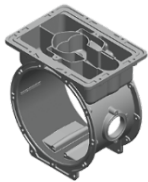

400A Center



400A side cover

Meter	Part Description	Part Number
400A	Center casting	109387-0500
400A	Side cover, 25 PSIG MAOP	80002102-0500
400A	Side cover, 10 PSIG MAOP	109210SU
675A, 800A & 1000A	Center casting	55058102-0500
675A, 800A & 1000A	Side cover	550565-0500

Hand Hole Cover

Meter	Part Description	Part Number	
400A, 675A, 800A, & 1000A	Hand hole cover	091006-1501	

IDM Assembly

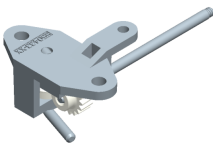

Meter	Part description	Part number
400A	IDM assembly (ft³)	035984
400A	IDM assembly (m³)	035986

Meter	Part description	Part number
675A, 800A & 1000A	IDM for ET top (ft ³)	555996
675A, 800A & 1000A	IDM for Standard top (ft ³)	555986
675A, 800A & 1000A	IDM for ET top (m ³)	555997
675A, 800A & 1000A	IDM for Standard top (m ³)	555987
675A, 800A & 1000A	IDM screws	015332
675A, 800A & 1000A	Male drive dog	550555

Seal Unit Assembly

Meter	Part Description	Part Number	
400A, 675A,800A & 1000A	Seal unit assembly	010935	

Drive Dog

Meter	Part Description	Part Number	
400A	Male	010530	
675A, 800A & 1000A	Male	550555	

Gaskets and O Rings



Meter	Part description	Part number
400A	Diaphragm gasket	065270
400A, 675A, 800A & 1000A	Hand-hole O-ring	091007
400A	Side cover, 10 PSI	109210-0500
400A	Side cover, 25 PSI	80002102-0500
400A	Top gasket	035511
675A, 800A & 1000A	Diaphragm O-ring	550551
675A, 800A & 1000A	Top gasket	550511

Index Mounting Bracket Assembly

Meter	Part Description	Part Number	
675A,800A & 1000A	Index mounting screws for indexes other than 8000027 series	010040-001	
675A,800A & 1000A	Index mounting screws for indexes commercial 800027 series	090071	
675A,800A & 1000A	Index mounting bracket	55045404	

Indexes



Meter	Part Description	Type	Part Number
400A ¹	Standard 4-circle dial/clock, (ft ³)	NTC	017312
400A ¹	Standard 4-circle dial/clock, (ft ³)	TC	017316
400A ¹	Standard 5-digit/direct read odometer (ft ³)	NTC	017321-001
400A ¹	Standard 4-digit/direct read odometer (ft ³)	NTC	017322-001
400A ¹	Standard 5-digit/direct read odometer (ft ³)	TC	017323-001
400A ¹	Standard 4-digit/direct read odometer (ft ³)	TC	017324-001
400A ³	Standard 5-digit/direct read odometer (m ³)	NTC	017325-001
400A ³	Standard 5-digit/direct read odometer (m ³)	TC	017326-001
400A ¹	2 PSI compensating, 4-circle (ft ³)	NTC & TC	017289
400A ¹	2 PSI compensating, 14.73 PSIA base, 4-circle, (ft ³)	NTC & TC	017289-001
400A ³	Standard 7-digit direct read, (m ³)	NTC	800027-011
400A ¹	2 PSI compensating, 14.73 PSIA base, 4-circle, (ft ³)	NTC & TC	017289-001
675A, 800A & 1000A ²	Standard 5-circle dial (ft ³)	NTC	050556
675A, 800A & 1000A ²	Standard 5-circle dial (ft ³)	TC	050557
675A, 800A & 1000A ²	Standard 5-digit direct read (ft ³)	NTC	800027-001

Meter	Part Description	Type	Part Number
675A, 800A & 1000A ²	Standard 5-digit direct read (ft ³)	TC	800027-002
675A, 800A & 1000A ⁴	Standard 6-digit direct read (m ³)	NTC	800027-003
675A, 800A & 1000A ⁴	Standard 6-digit direct read (m ³)	TC	800027-004
675A, 800A & 1000A ⁴	Standard 7-digit direct read (m ³)	NTC	800027-012
675A, 800A & 1000A ⁴	Standard 7-digit direct read (m ³)	TC	800027-013
675A, 800A & 1000A ²	14" compensating 5-circle dial (ft ³)	NTC & TC	048208

¹ Index Test Dials: ½', 2'

² Index Test Dials: 2 ½', 10'

³ Index Test Dials: 10dm³, 50dm³

⁴ Index Test Dials: .3m³, .15m³

Index Covers

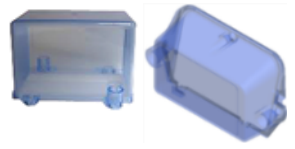
Meter	Part Description	Part Number	
400A	Standard index cover with boss and RTV	016610	
400A	Index cover without boss and RTV	015619	
675A, 800A & 1000A	Index cover with RTV	80006001	

Security Seal

Meter	Part description	Location	Part number	
400A, 675A, 800A & 1000A	Security seal cap (red)	Hand hole cover and index	017167	
400A	Security seal cap (red)	Case	017156	
675A, 800A & 1000A	Security seal cap (red)	Case	017152	

Seal Cup

Meter	Part Description	Location	Part number	
400A, 675A, 800A & 1000A	Seal cup	Hand hole cover and index	091061	
400A	Seal cup	Case	017155	
675A, 800A & 1000A	Seal cup	Case	017151	

Valve Covers

Meter	Part Description	Part Number	
400A	Valve cover 400A (lapped) Also Order:Valve Cover Bearing p/n 010372	037345	
675A & 800A	Valve cover 675A & 800A (lapped)	557331	
1000A	Valve cover 1000A (lapped)	550333	

Valve Cover Bearing

Meter	Part description	Part number	
400A	Valve cover/main shaft bearing	010372	
675A, 800A, 1000A	Valve cover/main shaft bearing	040375	

Valve Seat

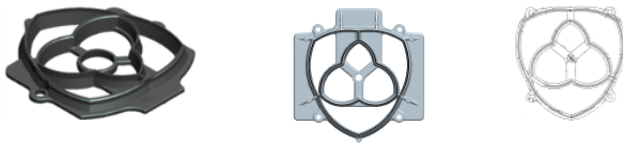

Meter	Part Description	Part Number
400A	Valve seat	036045
675A/800A	Valve seat lapped with bearing	556032
675A/800A	Valve seat lapped	556031
1000A	Valve seat lapped with bearing	550033
1000A	Valve seat lapped	550032

Ceiling Plate

Meter	Part Description	Part Number	
400A	Ceiling plate	030026	
675A, 800A & 1000A	Ceiling plate	550423	

Extension Plate

Meter	Part Description	Part Number	
675A, 800A, 1000A	Extension plate	550561	

Diaphragm Assembly

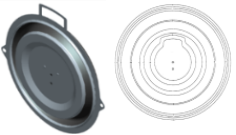
Meter	Part Description	Part Number	
400A	Diaphragm Assembly <i>Also order: hex nut part number 010820 (2)</i>	060238	
675A, 800A & 1000A	Diaphragm assembly <i>Also order: hex nut part number 110180 (2)</i>	550230	

Diaphragm Bracket

Meter	Part Description	Part Number	
400A	Diaphragm bracket <i>Also order: E-Ring part number 010172</i>	015202	
675A, 800A & 1000A	Diaphragm bracket <i>Also order: E-Ring part number 010175</i>	045194	

Carrier Wire Assembly

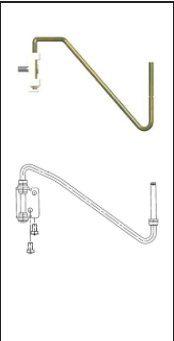
Meter	Part Description	Part Number	
400A	Carrier wire assembly <i>Also order: wire screw part number 010168-001</i>	070176	
675A, 800A & 1000A	Carrier wire bracket assembly <i>Also order: wire screw part number 010040-002 (2)</i>	550142	

Main Shaft Assembly

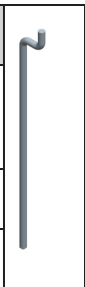
Meter	Part Description	Part Number	
400A	Main shaft <i>Also order: thrust bearing (060087)</i>	030095	
675A, 800A & 1000A	Main shaft assembly (NTC)	550959	
675A, 800A & 1000A	Main shaft assembly (TC)	550958	

Thrust Bearing

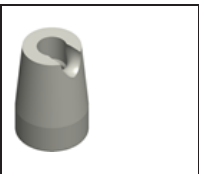
Meter	Part Description	Part number	
400A	Main shaft/center bracket seal assembly interface	060087	

Tangent Adjustment Assembly



Meter	Part description	Type	Units	Part number
400A	Adjustment assembly	NTC	ft ³ & m ³	090250
400A	Adjustment assembly	TC	ft ³ & m ³	090252
675A, 800A & 1000A	Adjustment assembly	NTC	ft ³ & m ³	045969

Meter	Part description	Type	Units	Part number
675A, 800A & 1000A	Adjustment assembly	TC	ft ³ & m ³	047978

Center Bracket Assembly

Meter	Part description	Part number	
675A, 800A & 1000A	Center bracket assembly	550938	
400A	Center bracket <i>Also order: Center bracket bearing boot seal</i>	010065 010389 060490	

Center Bracket Seal

Meter	Part Description	Part Number	
400A	Center bracket seal assembly	060490	

Center Bracket Lower Bearing

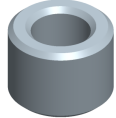
Meter	Part Description	Part Number	
400A	Center bracket lower bearing	010389	

Tangent Crank

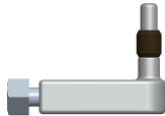
Meter	Part Description	Part Number	
675A & 800A	Tangent crank	550904	
1000A	Tangent crank	550902	

3 Badges

Meter	Part description	Type	Part number
400A, 675A, 800A & 1000A	Blank aluminum badge	N/A	017034
400A, 675A, 800A & 1000A	Aluminum embossed badge	N/A	017034EMB

4 Screws



Hand hole cover screw



Case screw

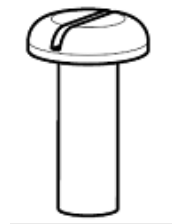

Index cover screw

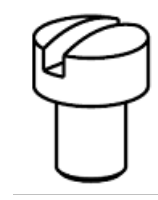

Index mounting screw

Meter	Part description	Location	Quantity	Part number
400A, 675A, 800A & 1000A	10-24 x 1/2 Slotted pan head	Hand hole cover	2	091096
400A, 675A, 800A & 1000A	Rivet 1/8 x 0.254	Badge	2	091444
400A	Index, valve seat, and carrier wire		2	010622-001
400A	10-24 x 5/8 cross-slotted	Standard index cover	3	010625-002
400A	10-24 x .775 cross-slotted	Itron AMR index cover	2	010626-002
400A	Drilled head for seal wires on standard meters		2	010627-002
400A	10-24 x 3/8 Fillister Head index mounting screw	Index	2	010040-002
400A	10-24 x 3/8 Fillister head	Valve seat	2	010040-002
400A	1/4-20 x 3/4 Hex head	Top case	8	755304-001
400A	1/4-20 x 5/8 Wash face	Side cover	22	010323-002
675A, 800A & 1000A	1/4-20 x 5/8 Soc head cap screw	Valve seat	4	091103-001
675A, 800A & 1000A	5/16-18 x 3/4 Hex head	Top case	18	040320-001
675A, 800A & 1000A	5/16-18 x 1 HD Head screw	Side cover	30	550321-001

Meter	Part description	Location	Quantity	Part number
400A, 675A, 800A & 1000A	10-24 x 7/16 Wash head SLF TP	IDM housing	2	015332-001
675A, 800A & 1000A	1/4-20 x 1/2 Hex head slotted	Index cover	4	010320-001
675A, 800A & 1000A	10-24 x 3/8 Fillister head	Index mounting bracket	2	010040-002
675A, 800A & 1000A	6-32 x 1 TRI RNDLR taptite	Index mounting screw for direct read indexes	2	090071
675A, 800A & 1000A	10-24 x 3/8 Fillister head	Index mounting screw for dial indexes	2	010040-002
675A, 800A & 1000A	1/4-20 x 1/2 Hex head slotted	Index bracket screw for Standard and ET top	2	010320-001
675A, 800A & 1000A	1/4-20 x .375 Fillister head	Index bracket screw for Itron adapter plate	2	550622

5

Special Tools



80003601/550430



(80003601 end view)



(550430 end view)



012253

Tool part number	Tool description
80003601	400A proving wrench
550430	Commercial proving wrench
012253	IDM tool for 400A, 675A, 800A, 1000A

6

Meter Connections

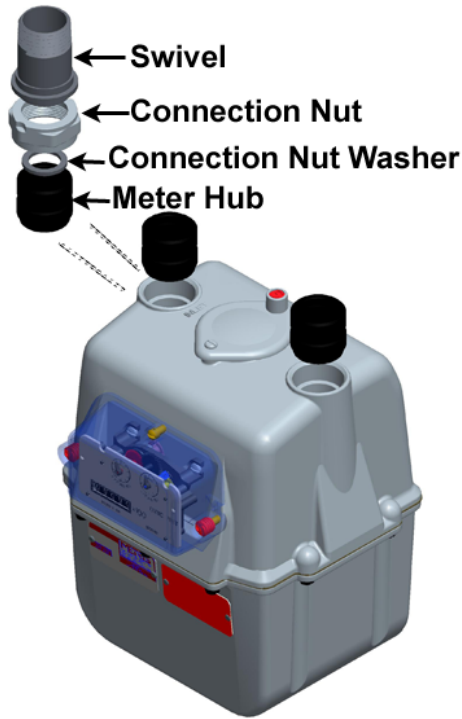

10LT Swivels

Part Number	Part Description	
013322	10 LT x 3/4M galvanized swivel	
013324	10 LT x 3/4M galvanized swivel with plug	
013243	10 LT x 3/4M galvanized, insulated swivel	

10 LT Connection Nut Washer

Part number	Part description	
015660	10 LT connection nut washer	

10 LT Connection Nut Tin

Part number	Part description	
010642	10 LT connection nut tin	

10 LT Connection Nut Washer

Part number	Part description	
013409	10 LT galvanized connection nut	

#1 Sprague/1A Standard Swivels

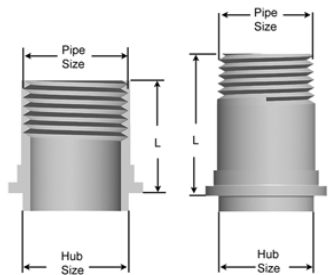
Part Number	Part Description	
013110	#1 Sprague/1A Standard x 1M M.I.* black swivel	
013132	#1 Sprague/1A Standard x 1M black swivel with plug	
013247	#1 Sprague/1A Standard x 1M black, insulated swivel	
013147	#1 Sprague/1A Standard x 1M black insulated swivel with plug	
013111	#1 Sprague/1A Standard x 1M galvanized swivel	
013129	#1 Sprague/1A Standard x 1M galvanized swivel with plug	
013223	#1 Sprague/1A Standard x 1M galvanized, insulated swivel	
013145	#1 Sprague/1A Standard x 1M galvanized, insulated swivel with plug	
013107	#1 Sprague/1A Standard x 3/4F galvanized swivel	
013205	#1 Sprague/1A Standard x 3/4F galvanized, insulated swivel	
013215	#1 Sprague/1A Standard x 3/4M galvanized, insulated swivel	
013114	#1/1A Standard x 3/4M M.I.* black swivel	

*malleable iron

#1 Sprague/1A Standard Connection Nut

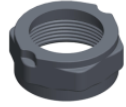
Part number	Part description	
010692	#1 Sprague/1A Standard black connection nut	
013403	#1 Sprague/1A Standard galvanized connection nut	

#1 Sprague/1A Standard Connection Nut Washer

Part number	Part description	
015650	#1 Sprague/1A Standard connection nut washer	

#1 Sprague/1A Standard Connection Blind Washer

Part number	Part description	
015648	#1 Sprague/1A Standard blind washer	

1-1/4" (1" Pittsburgh) Swivels

(same as 1A swivels)

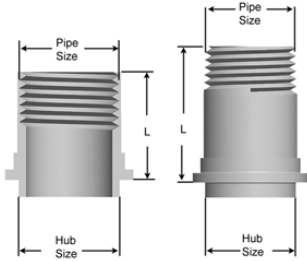
Part number	Part description	
013110	#1 Sprague/1A Standard x 1M M.I.* black swivel	
013132	#1 Sprague/1A Standard x 1M black swivel with plug	
013247	#1 Sprague/1A Standard x 1M black, insulated swivel	
013147	#1 Sprague/1A Standard x 1M black insulated swivel with plug	
013111	#1 Sprague/1A Standard x 1M galvanized swivel	
013129	#1 Sprague/1A Standard x 1M galvanized swivel with plug	
013223	#1 Sprague/1A Standard x 1M galvanized, insulated swivel	
013145	#1 Sprague/1A Standard x 1M galvanized, insulated swivel with plug	
013107	#1 Sprague/1A Standard x 3/4F galvanized swivel	
013205	#1 Sprague/1A Standard x 3/4F galvanized, insulated swivel	
013215	#1 Sprague/1A Standard x 3/4M galvanized, insulated swivel	

1-1/4" (1" Pittsburgh) Connection Nut

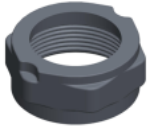
Part number	Part description	
013412	1-1/4" black connection nut	
013414	1-1/4" galvanized connection nut	
013402	1-1/4" plated connection nut	

1-1/4" (1" Pittsburgh) Connection Nut Washer

(same as 1A connection nut washer)

Part number	Part description	
015650	#1 Sprague/1A Standard connection nut washer	

20 LT Swivels

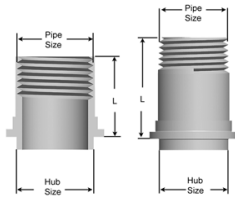
Part number	Part description	
063095	20 LT x 1M black swivel	
063092	20 LT x 1M black, insulated swivel	
063096	20 LT x 1M galvanized swivel	
063094	20 LT x 1M galvanized, insulated swivel	
013216	20 LT x 3/4M galvanized swivel	
013217	20 LT x 3/4M galvanized, insulated swivel	
013241	20 LT x 3/4F galvanized swivel	
063095	20 LT x 1M black swivel	

20 LT Connection Nut

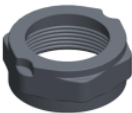
Part number	Part description	
063415	20 LT black connection nut	
063417	20 LT galvanized connection nut	

20 LT Connection Nut Washer

Part number	Part description	
015664	20 LT connection nut washer	

20 LT Connection Nut Tin

Part number	Part description	
015640	20 LT connection nut tin	

30 LT Swivels

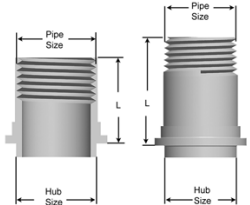
Part number	Part description	
013130	30 LT x 1-1/4 M black swivel	
013225	30 LT x 1-1/4M black, insulated swivel	
013131	30 LT x 1-1/4M galvanized swivel	
013226	30 LT x 1-1/4M galvanized, insulated swivel	

30 LT Connection Nut

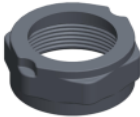
Part number	Part description	
013401	30 LT black connection nut	
013405	30 LT galvanized connection nut	

30 LT Connection Nut Washer

Part number	Part description	
015657	30 LT connection nut washer	

30 LT Connection Nut Tin

Part number	Part description	
015643	30 LT connection nut tin	

45 LT Swivels

Part number	Part description	
033235	45 LT x 1-1/2M Black swivel	
033251	45 LT x 1-1/2M Black, insulated swivel	
033113	45 LT x 1-1/2M Galvanized swivel	
033114	45 LT x 1-1/2M Galvanized, insulated swivel	
033127	45 LT x 1-1/4F PLTD swivel	

45 LT Connection Nut

Part number	Part description	
033417	45 LT Black connection nut	
033401	45 LT Galvanized connection nut	

45 LT Connection Nut Washer

Part number	Part description	
035656	45 LT Connection nut washer	

#3 Sprague (#4) Swivels

Part number	Part description	
033110	#3 Sprague (#4) x 1-1/2 M black swivel	
033111	#3 Sprague (#4) x 1-1/2 M galvanized swivel	
033234	#3 Sprague (#4) x 1-1/2 M galvanized, insulated swivel	
033128	#3 Sprague (#4) x 1-1/2 M galvanized, insulated with plug	

#3 Sprague (#4) Connection Nut

Part number	Part description	
030692	#3 Sprague (#4) Black connection nut	
033403	#3 Sprague (#4) Galvanized connection nut	

#3 Sprague (#4) Connection Nut Washer

Part number	Part description
035650	#3 Sprague (#4) Connection nut washer

#5 Swivels

Part number	Part description
053100	#5 x 2F M.I. Black swivel
053102	#5 x 2F Plated swivel
053230	#5 x 2F Plated, insulated swivel

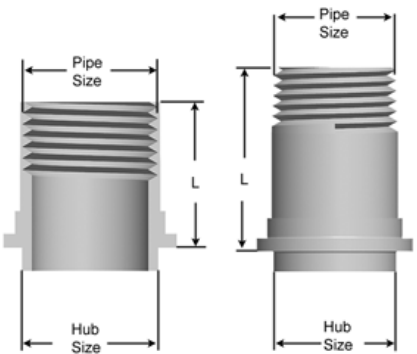

#5 Connection Nut

Part number	Part description
050692	#5 Standard black connection nut
053403	#5 Standard galvanized connection nut

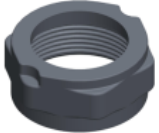

#5 Connection Nut Washer

Part number	Part description
055650	#5 Connection nut washer

100 LT Swivels

Part number	Part description
053094	100 LT x 2M galvanized swivel
053095	100 LT x 2M insulated swivel

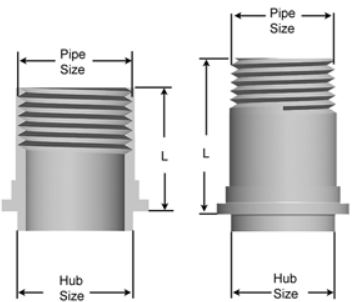

100 LT Connection Nut

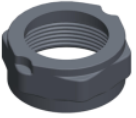
Part number	Part description	
053416	100 LT Galvanized connection nut	

100 LT Connection Nut Washer

Part number	Part description	
055621	100 LT Connection nut washer	